

Strikelt4

Low Current Locking Device Power Controller

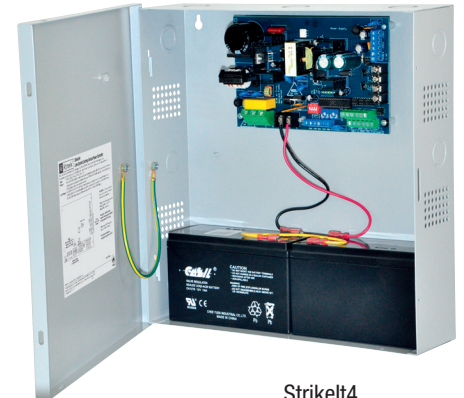

Altronix Strikelt4 will operate up to two (2) low current lock hardware devices simultaneously. It is designed to operate motorized electric latch retraction exit devices, electric strikes, mag-locks, electric mortise and cylindrical locksets, etc. Each lock output has an adjustable re-lock delay timer. It will control a pair of doors simultaneously, or independently control two single door leaves. Strikelt4 has integrated output relays which trigger automatic door operators and control ADA activation push plates/accessories. In addition, one (1) 12VDC and one (1) 24VDC unswitched auxiliary voltage outputs are provided for powering ancillary devices. A configurable FACP interface will either remove or apply power from the lock outputs when activated. LED status indicators are provided to monitor input status, battery condition, AC power loss, and FACP status. Intelligent logic provides protection against accidental shorting of lock outputs.



Strikelt4
(order batteries separately)

Specifications

Input

Voltage	115VAC, 60Hz, 2.5A or 230VAC, 50Hz, 1.5A Two (2) Normally Open (N.O.) trigger inputs FACP Normally Closed (N.C.) input Two normally open ADA inputs for special mode of interfacing with automatic door operators
----------------	--

Fusing	Input fuse rating: 3A
---------------	-----------------------

Outputs

Power options:

- Two (2) 19.8VDC-26.4VDC rated individually controlled lock outputs configurable for fail-secure or fail-safe electronic locking hardware for applications with battery back-up. 24VDC-26.4VDC rated for applications without battery back-up (US applications only). Current rating 2A combined
- One (1) 19.8VDC-26.4VDC @ 0.8A rated filtered regulated auxiliary output for applications with battery back-up, 24VDC-26.4VDC @ 0.8A rated for applications in US not equiring battery back-up Not affected by FACP trigger
- One (1) 12VDC filtered regulated auxiliary output rated 0.5A Not affected by FACP trigger
- Two (2) follower Normally Open relay outputs for controlling ADA actuators/accessories rated 28VDC @ 0.5A
- Two momentary door operator activation relay outputs
- Trouble relay output indicating low AC voltage trouble and battery trouble

Battery Charging

Capacity	7AH/12VDC (2 within enclosure) Larger batteries require separate enclosure
Type	Sealed lead acid or gel type
Failover	Upon AC loss, instantaneous
Batteries are sold separately	
When 7AH batteries are used, battery capacity for emergency stand-by is 30 minutes	

Fire Alarm Disconnect

- Normally Closed FACP trigger input
Programmable Fire Alarm Disconnect options:
- Removes power to outputs and disables delayed follower relays
 - Connects power to lock outputs and enables delayed follower relays

Indicators (LED)

AC Power (Green)	Input voltage is present
Trigger Output (Red)	Panic device status/trouble
FAI (Green)	FACP disconnect
Battery (Red)	Low battery

Agency Listings

UL	
UL 294	Access Control Unit Power Supply
cUL	
ULC-S319	Access Control Unit Power Supply. Class 1

Physical and Environmental

Dimensions (H x W x D)	
Enclosure:	13.5" x 13" x 3.25" (342.9mm x 330.2mm x 82.6mm)
Shipping:	15" x 13.875" x 4.75" (381mm x 352.4mm x 120.6mm)
Enclosure accommodates up to two (2) 12VDC/7AH batteries	

Weight (approx.)

Product Weight:	6.25 lb. (2.83 kg)
Shipping Weight:	7.15 lb. (3.24 kg)

Temperature

Operating:	0°C to 49°C (32°F to 120°F)
Storage:	- 20°C to 70°C (- 4°F to 158°F)

Relative Humidity	85% +/- 5%
--------------------------	------------

BTU/Hr. (approx.):	36 BTU/Hr.
---------------------------	------------

Lifetime Warranty

Dimensions and Drawing

Dimensions (H x W x D approximate)

13.5" x 13" x 3.25" (342.9mm x 330.2mm x 82.55mm)

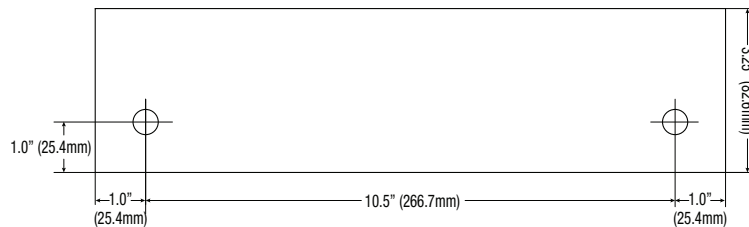
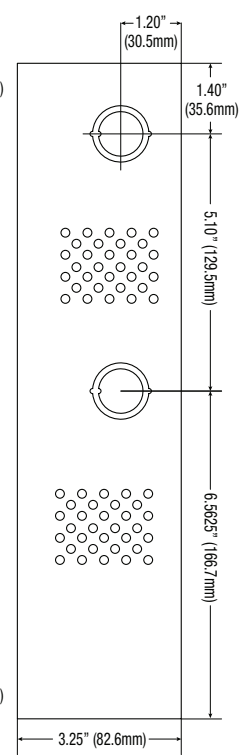
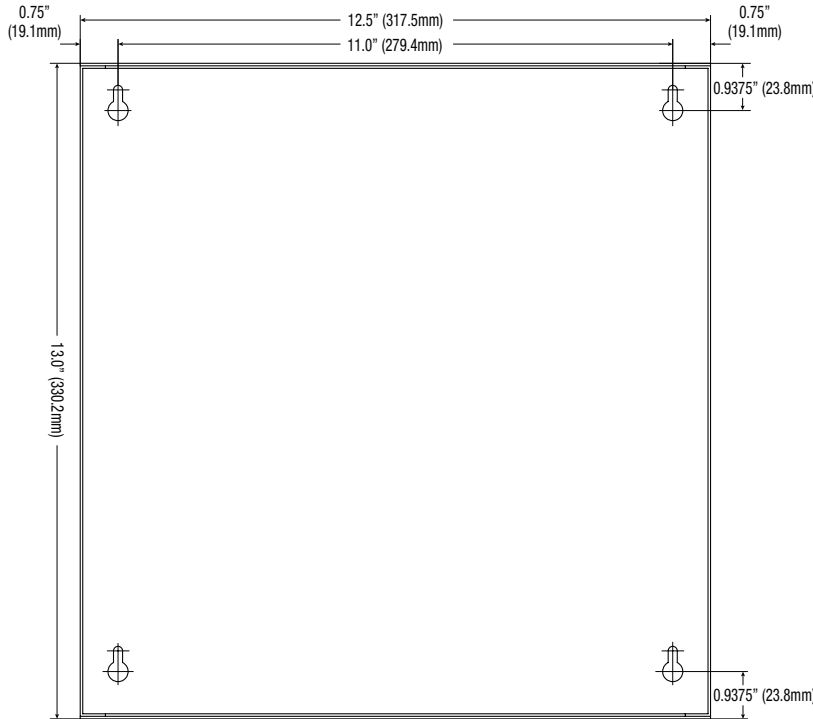
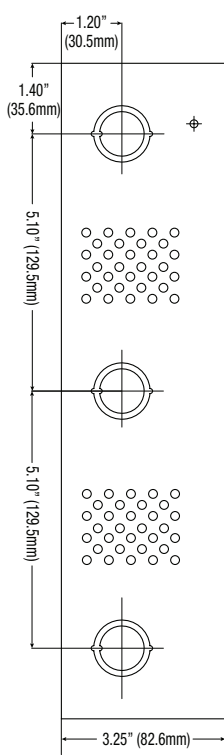
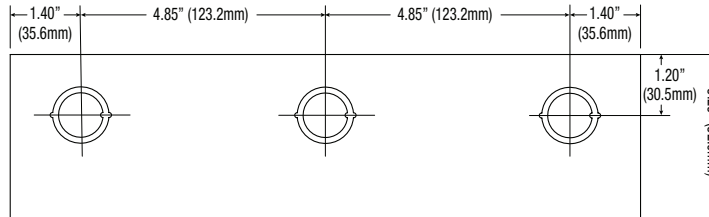

Lifetime Warranty

Altronix Corporation | 140 58th St | Brooklyn, NY 11220 USA

phone: +1 718.567.8181 | fax: +1 718.567.9056 | email: info@altronix.com | www.altronix.com